

**SOMERSET COUNCIL**  
**VARIOUS ROADS, FROME**  
**(SCHOOL STREET – PEDESTRIAN AND CYCLE ZONE)**  
**(PROHIBITION OF MOTOR VEHICLES) AND (20MPH ZONE) AND**  
**(PROHIBITION OF WAITING)**  
**EXPERIMENTAL ORDER 2024**

Somerset Council in exercise of the powers under Sections 1, 2, 4, 9 and 10 of, and Part IV of Schedule 9 to, the Road Traffic Regulation Act 1984 (the Act of 1984), as amended, and of all other enabling powers and after consultation with the Chief Officer of Police in accordance with Part III of Schedule 9 to the Act of 1984, hereby make the following Order:-

1. This Order shall come into force on the 22nd April 2024 and will remain in force for a maximum period of 18 months and may be cited as "Somerset Council Various Roads Frome (School Street - Pedestrian and Cycle Zone) (Prohibition of Motor Vehicles) and (20mph Zone) and (Prohibition of Waiting) Experimental Order 2024".

2. In this order, except where the context otherwise requires, the following expressions shall have the meanings applied to them: -

"Motor Vehicle" has the same meaning as that in Section 136 of the Road Traffic Regulation Act 1984.

"Driver" in relation to a vehicle waiting in a parking place, means the person driving the vehicle at the time it was left in such a parking place.

"Resident" means a person whose usual place of residence is at the postal address of which is situated in any parts of the roads identified as a Restricted Road in the Schedules to this Order.

"Restricted Road" means the lengths of roads specified in schedules to this order.

"Bus" has the same meaning as Public Service Vehicle as in Section 1 of the Public Passenger Vehicles Act 1981.

"Vehicle" means a vehicle of any description and includes a machine or implement of any kind drawn or propelled along roads whether by animal or mechanical power.

"Contractual Vehicle" means a Bus, Private Hire Vehicle or Taxi, contracted by the Council and/or school, to take children to or from a school which is fronting or adjacent to the Restricted Roads.

"Disabled Person's Badge" has the same meaning as in The Disabled Persons (Badges for Motor Vehicles) (England) Regulations 2000 (SI 2000 No.682 as amended by SI 2000 No.1507 and SI 2007 No.2531)

"Disabled Person's Vehicle" has the same meaning as in Section 142 of the Act  
"Healthcare Worker" means;

(a) Any such persons currently identified by an NHS Trust (or any other name that it may subsequently be known) as being a general practitioner, doctor, registered nurse, or any other nominated medical persons undertaking domiciliary visits to patients residing within premises accessible by vehicle only from a Restricted Road; or

(b) Any such persons as are authorised by the Council to be essential healthcare or family support visitors to patients residing within premises accessible by vehicle only from Restricted Road.

“Taxi” is a vehicle licensed as a hackney carriage under the Town Police Clauses Act 1847 as amended.

“Private Hire Vehicle” has the same meaning as in Section 13 of the Transport Act 1985.

“Term Time” means the part of the year during which the schools are open for holding classes.

“Schools” means a school situated on the length of a Restricted Road.

“Council” means Somerset Council.

“School staff” means any person working either full or part time at a school situated on the length of a Restricted Road.

3. The provisions of any other orders are hereby revoked but only as far as they are affected by the restrictions of this Order.
4. No person shall, except under the direction or with the permission of a police officer in uniform or a police community support officer, cause or permit any vehicle to enter or proceed in the roads as specified in Schedules 1, 2 and 3 to this Order.
5. No person shall, except under the direction or with the permission of a police officer in uniform, shall drive any motor vehicle at a speed exceeding 20 miles per hour on the lengths of road specified in Schedule 4 to this Order.
6. No person shall, except under the direction or with the permission of a police officer in uniform or a police community support officer, cause or permit any vehicle to wait at any time on any parts of the roads specified in Schedule 5 to this Order (as shown on map tile BF249).
7. Nothing in Article 4 of this Order shall apply to any vehicle being used:
  - a) to access residential properties and associated land or buildings adjacent to a restricted road, to include Harry's Hydrotherapy Pool (Critchill School)
  - b) in connection with any building operation or demolition in or adjacent to that road, the removal of any obstruction to traffic, the maintenance, improvement or reconstruction of any of the lengths of road so referred,

or the laying, erection, alteration or repair in or near to any of the said lengths of road of any sewer, or of any main pipe or apparatus for the supply of gas, water or electricity or of any apparatus as defined in Paragraph 1 (1) of the Telecommunication Code contained in Schedule 2 to the Telecommunications Act, 1984;

- c) if said vehicle cannot conveniently be used for such purpose in any other road to be used in the service of a local authority, the Environment Agency, a water undertaker, or sewerage undertaker in pursuance of certain statutory powers or duties.
- d) for Police Service, Fire and Rescue Service or Ambulance Service purposes.
- e) vehicles falling within regulation 3(1), 3(2), 3(3) and 3(4) of the Road Traffic Exemptions (Special Forces) (Variation and Amendment) Regulations 2011(a) when used in accordance with regulation 3(5) of those Regulations.
- f) in the service of the Council being necessarily used in connection with highway maintenance, parking enforcement, waste collection or street cleansing activities in pursuance of statutory powers and duties.
- g) in connection with a contracted vehicle (Buses and Taxis) in a Restricted Road between the hours referred to in Article 4 where the vehicle is contracted by the local education authority (but only for the purpose of dropping off or picking up school children).
- h) in the service of a universal service provider as defined in section 4 of the Postal Services Act 2011 being used for delivering or collecting postal packets from premises that can only be accessed via a Restricted Road.
- i) to access a property on a Restricted Road if it cannot conveniently be used for such purpose in any other road by a Healthcare Worker whilst undertaking healthcare worker duties where evidence is provided to show reason.
- j) a disabled persons vehicle seeking access to any school and associated land or buildings adjacent to a restricted road.
- k) by school staff seeking access to any school and associated land or buildings adjacent to a restricted road.
- l) by parents or guardians of children with an Education, Health and Care plan seeking access to any school and associated land or buildings adjacent to a restricted road.
- m) In relation to scheduled bus services seeking access to any bus stop located on a restricted road.

- n) to access premises to tend to the health and welfare of animals, whether or not the premises are adjacent to a Restricted Road, in cases where the health and welfare of said animals would otherwise be at risk.
8. Pursuant to Section 10(2) of the Act of 1984, the Director of Climate and Place or any other person duly authorised by the Council may modify or suspend the operation of this Order or any provision if it appears essential:-
- (a) in the interest of the expeditious, convenient and safe movement of traffic;
  - (b) for preserving or improving the amenities of the area through which any road affected by this Order runs or
  - (c) in the interest of providing suitable and adequate on street parking facilities;
9. The restrictions imposed by this Order shall be in addition to and not in derogation of any restrictions or requirements imposed by any regulations made or having effect as if made under the Act of 1984 or by or under any other enactment.

GIVEN under the Common Seal of the Council this 17th day of April 2024.

THE COMMON SEAL of the )  
COUNCIL of SOMERSET )  
was hereunto affixed )  
in the presence of )



No. in Register CH3037

**SCHEDULE 1**

**OAKFIELD ROAD SCHOOL STREET – PEDESTRIAN AND CYCLE ZONE**

**Prohibition of Motor Vehicles**

**Monday – Friday (During School Term Time Only)**

**Between the hours of 8.10am and 9am and  
between the hours of 2.45pm and 3.30pm**

Oakfield Road	from its junction with Egford Hill, southwards to its junction with Nunney Road
Oakfield Close	for its entire length
The Old Nurseries	for its entire length

**SCHEDULE 2**

**NUNNEY ROAD AND CRITCHILL SCHOOL STREET – PEDESTRIAN AND  
CYCLE ZONE**

**Prohibition of Motor Vehicles**

**Monday – Friday (During School Term Time Only)**

**Between the hours of 8.10am and 9am and  
between the hours of 2.45pm and 3.30pm**

Critch Hill	from the junction with Whitemill Lane, eastwards to Nunney Road
Nunney Road	from Critch Hill, eastwards to its junction with Oakfield Road
Tadley Meadow	for its entire length
Whitemill Lane	for its entire length

**SCHEDULE 3**

**PARK ROAD SCHOOL STREET – PEDESTRIAN AND CYCLE ZONE**

**Prohibition of Motor Vehicles**

**Monday – Friday (During School Term Time Only)**

**Between the hours of 8.25am and 8.55am and  
between the hours of 3.00pm and 3.30pm**

Park Road	for its entire length
-----------	-----------------------

**SCHEDULE 4**  
**FROME SCHOOL STREET – 20 MPH ZONE**

Oakfield Road	from a point 37 metres north of the property boundary between Nos 65 and 67 Oakfield Road, to its junction with Dommetts Lane
Nunney Road	from the property boundary between Nos 72 and 74 Nunney Rd, to its junction with A362 Broadway
Critch Hill Road	from its junction with Oakfield Road to its junction with Whitewell Road
Portland Road	for its entire length
Portland Place	for its entire length
Lynfield Road	for its entire length
Nunney Barton	for its entire length
Dommetts Lane	for its entire length
Queens Road	for its entire length
Weymouth Road	for its entire length
Back lane off Weymouth Road	for its entire length
Somerset Road	for its entire length
St Aldehelm's Close	for its entire length
The Acorns	for its entire length
Ecos Court	for its entire length
Whitewell Road	for its entire length
Whitewell Place	for its entire length
Delmore Road, including Firwood Road	for its entire length
Malthouse Court	for its entire length
Richmond Road	for its entire length
Stourton View, including Stourton Gardens and Stourton Close	for its entire length
Weavers Court	for its entire length
Felsberg Close	for its entire length
Green Lane	for its entire length
Westfield Road	for its entire length
Churchill Road	for its entire length
Flints Close	for its entire length
Barn Close	for its entire length
Beverley Close	for its entire length
Critchill Close	for its entire length
Westover	for its entire length
Westover Court	for its entire length
Catherson Close	for its entire length
Yeomans Lodge	for its entire length
Warleigh Close	for its entire length
Westwood Drive	for its entire length

Eastwood Close  
 Lynwood Close  
 Orchard Close  
 Whitemill Lane

for its entire length  
 for its entire length  
 for its entire length  
 for its entire length

**SCHEDULE 5**

**No Waiting at any time (double yellow lines)**

<b>Map Title</b>	<b>Effective date</b>
BF249	22 <sup>nd</sup> April 2024

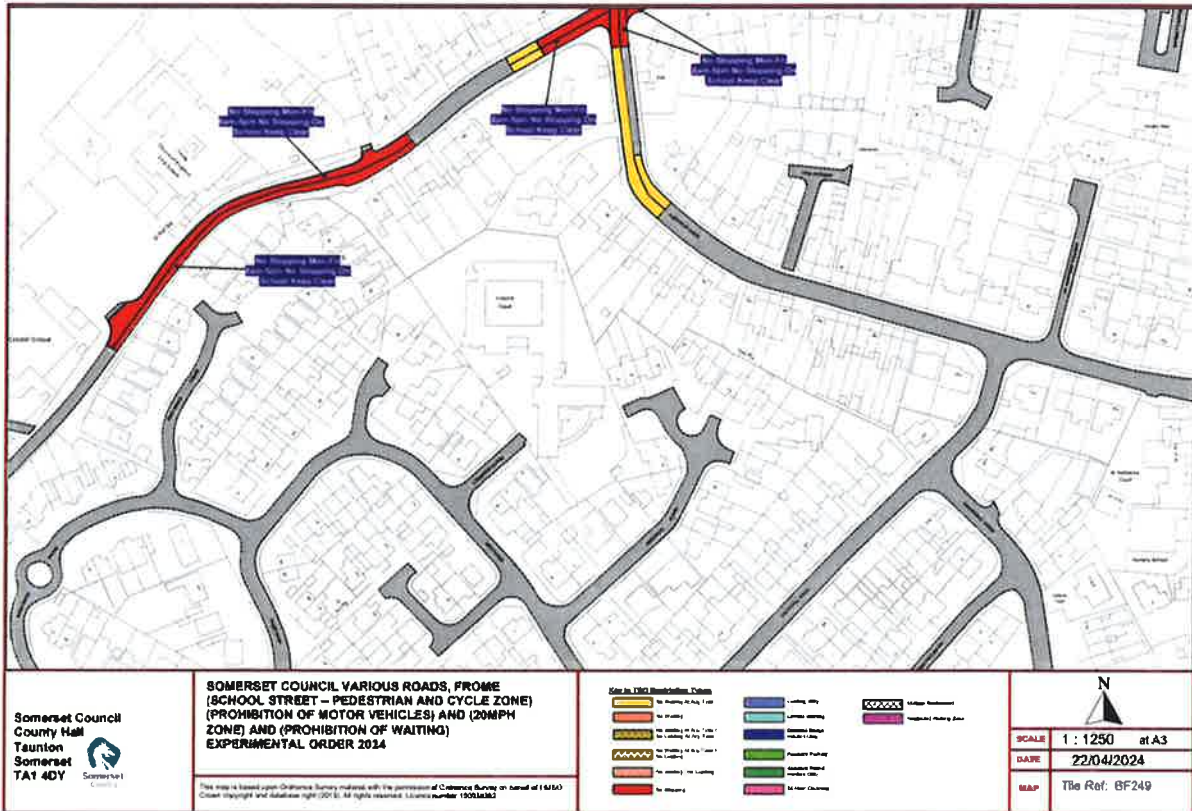

**STATEMENT OF REASONS FOR PROPOSING TO MAKE THE ORDER**

The Council’s reasons for proposing to make the above Order are as follows:-

The Frome School Streets scheme is proposed to make conditions safer for walking and cycling to and from four of Frome’s schools- Trinity (primary), Oakfield Academy (middle), Avanti (primary), and Critchill (primary). The proposed scheme has been designed by Sustrans for Frome Town Council in consultation with the community. The intention is to implement the scheme for a trial period of 18 months, to monitor its effectiveness in reducing traffic, improving safety, and increasing levels of active travel on the school run. In addition to the School Street trial, Sustrans has also secured some additional Department for Transport funding to make Quietway improvements to Somerset and Oakfield Roads, as these form part of the National

Cycle Network (NCN) route 24. This funding is to create a slow speed environment that better facilitates active travel.

The Experimental Order has been made to allow for an assessment of the changes before a decision is taken to make it permanent.



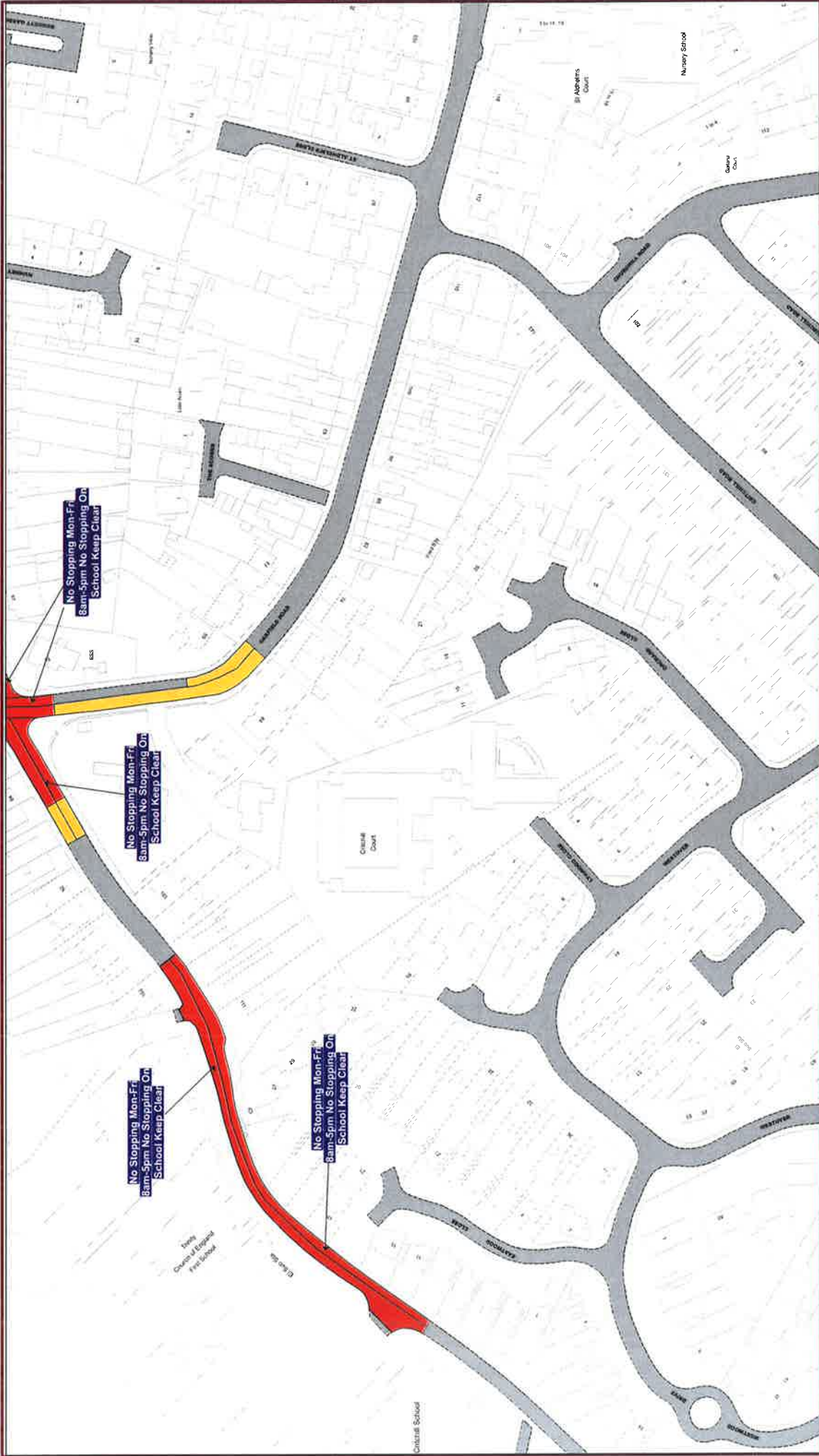

SCALE	1 : 1250	at A3
DATE	22/04/2024	
MAP	Tile Ref: BF249	

Key to TRO Restriction Types	
	No Waiting at Any Time
	No Waiting
	No Waiting at Any Time / No Loading at Any Time
	No Waiting at Any Time / No Loading
	No Waiting / No Loading
	No Stopping
Multiple Restrictions	
	Loading Only
	Limited Waiting
	Pushed Back
	Payment Parking
	Reduced Hours
	At Hour Quaiway
	Restricted Parking Zone

**SOMERSET COUNCIL VARIOUS ROADS, FROME (SCHOOL STREET - PEDESTRIAN AND CYCLE ZONE) (PROHIBITION OF MOTOR VEHICLES) AND (20MPH ZONE) AND (PROHIBITION OF WAITING) EXPERIMENTAL ORDER 2024**

This map is based upon Ordnance Survey material with the permission of Ordnance Survey on behalf of HMSO Crown copyright and database right (2019). All rights reserved. Licence number 100098952.

  
**Somerset Council**  
 County Hall  
 Taunton  
 Somerset  
 TA1 4DY



# Various Roads, Frome - 20mph Zone - Experimental TRO Plan

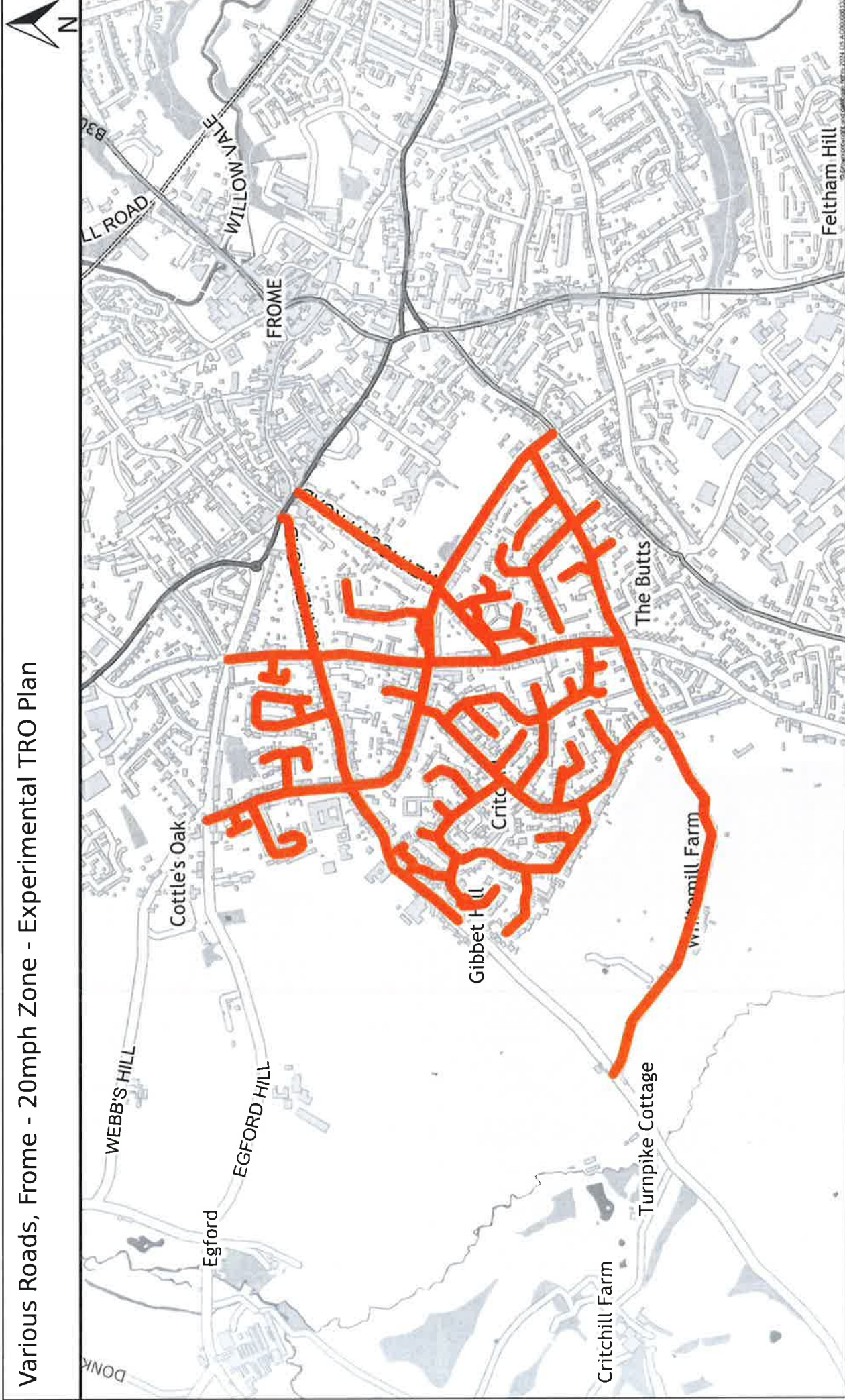

Somerset  
Council  
County Hall  
Taunton  
TA1 4DY  
0300 123 2224



Scale: 1:10000

Centre: 376822, 147636

Date produced: 2024-03-27

10:00:33

© Crown copyright and database rights 2023 OS AC0000861332. You are granted a non-exclusive, royalty free, revocable licence solely to view the Licensed Data for non-commercial purposes for the period during which Somerset Council makes it available. You are not permitted to copy, sub-license, distribute, sell or otherwise make available the Licensed Data to third parties in any form. Third party rights to enforce the terms of this licence shall be reserved to OS.



# Various Roads, Frome - Pedestrian and Cycle Zone - Experimental TRO Plan

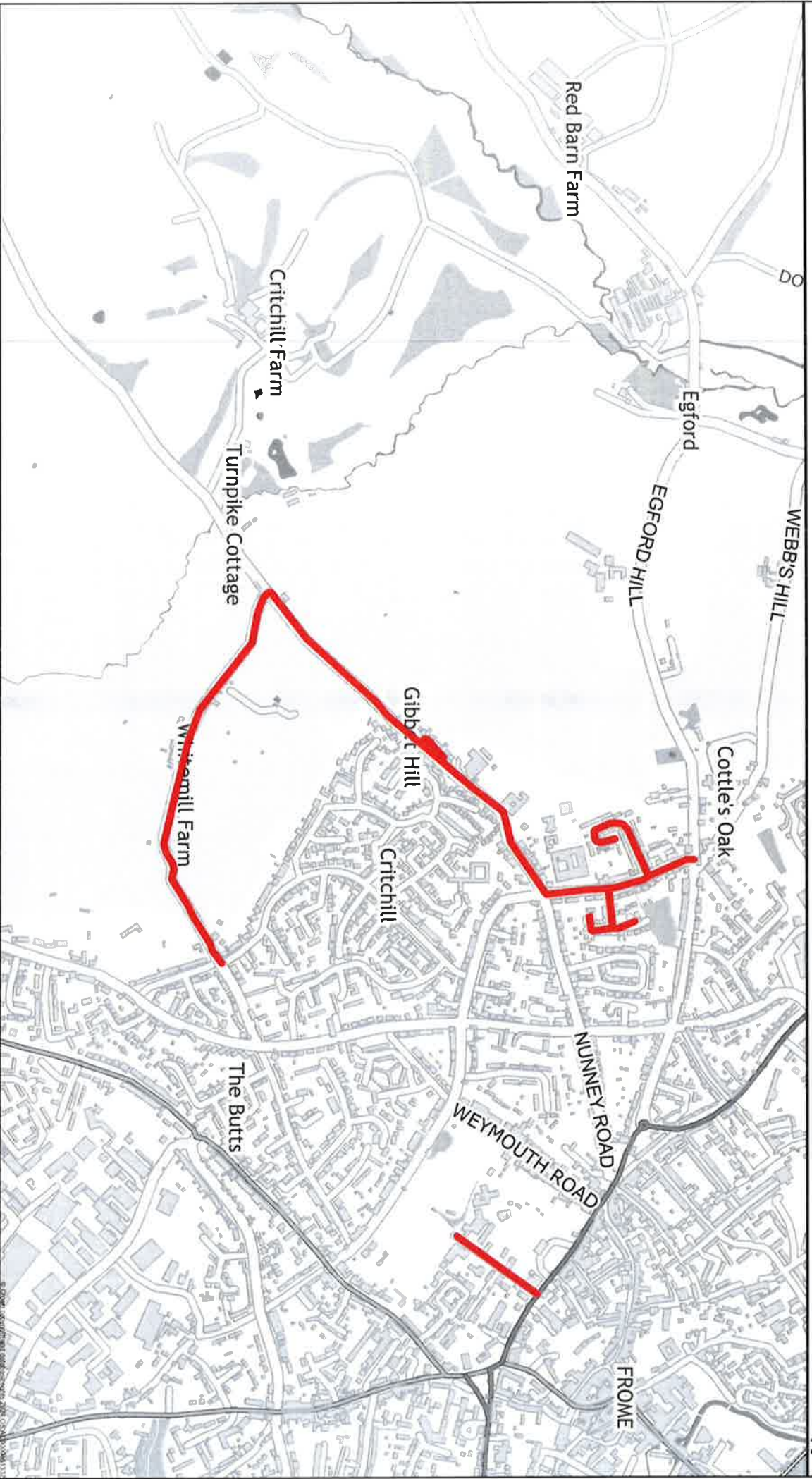

**Somerset**  
Council

Somerset  
Council  
County Hall  
Taunton  
TA1 4DY  
0300 123 2224

Scale: 1:10000

Centre: 376322, 147594

Date produced: 2024-03-27

11:05:41

© Crown copyright and database rights 2023 OS AC0000861332. You are granted a non-exclusive, royalty free, revocable licence solely to view the Licensed Data for non-commercial purposes for the period during which Somerset Council makes it available. You are not permitted to copy, sub-licence, distribute, sell or otherwise make available the Licensed Data to third parties in any form. Third party rights to enforce the terms of this licence shall be reserved to OS.